

LFD-200

NETWORK TESTING—ACCESS



- No need to open fiber for identification
- Hands-free operation via Hold button
- Three interchangeable adapter heads
- Extended range model: 23 to -50 dBm

No-Disconnection Live Fiber Detection

The LFD-200 Live Fiber Detector allows you to detect traffic and measure signals anywhere on singlemode fibers without having to disconnect them. It also lets you check for signal presence before rerouting or maintenance, perform continuity tests and verify cable labeling. Based on non-destructive macrobending technology, the LFD-200 doesn't disrupt traffic, damage or overstress the fiber, enabling efficient, accurate and reliable data acquisition.

Simple Testing of Multiple Fiber Types

EXFO's LFD-200 is the only instrument of its kind on the market that comes with a choice of three built-in, interchangeable adapter heads, making it an all-in-one solution for live fiber detection. The handle's storage compartment holds the extra adapter heads for simple conversion and easy testing of various fiber types.

The LFD-200 also features a unique Hold button that enables hands-free operation. Just slide the button up and over to lock it in place. You are now free to operate your setup.

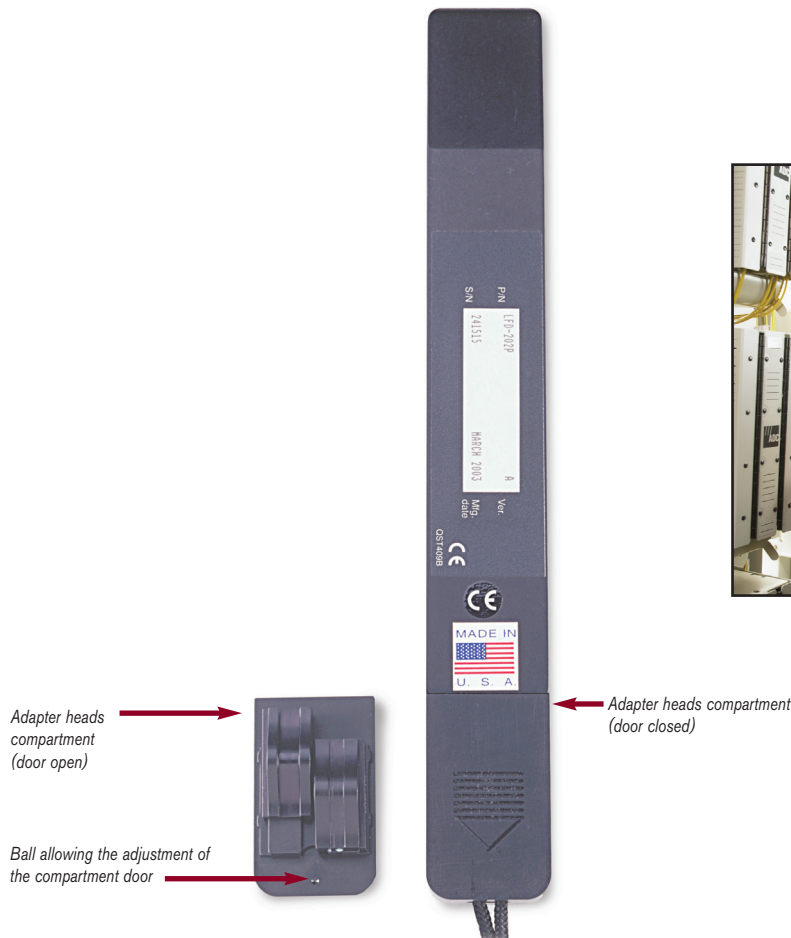

Complete Diagnosis. Fast.

Simply clamp the LFD-200 onto a fiber, listen for a beep indicating the presence of traffic, then view a complete status report on the multifunction LED display:

- Signal presence or absence (live or dark fiber)
- Signal type (customer traffic, continuous or modulated test signal at 270 Hz, 1 kHz or 2 kHz)
- Signal direction
- Core power within 2 dB (typical)

LFD-200 Series: Models and Features

	LFD-201	LFD-202	LFD-202E
Core power display		✓	✓
Maximum power range (dBm)	0 to -40	0 to -40	23 to -50
Over-range indicator		✓	✓
Fiber type	Single fiber	Single fiber	Single fiber
Fiber heads (included)	3 mm 900 250/RIB	3 mm 900 250/RIB	3 mm 900 250/RIB
Optional 2 mm head	✓	✓	✓
Optional 1.6 mm head			✓

Standard Accessories (Interchangeable Heads)

LFD-201, LFD-202 and LFD-202E

3 mm

Extra head for jacketed fiber (3 mm)



900

Extra head for jacketed fiber (900 mm)

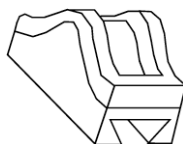

250/RIB

Extra head for coated fiber (250 μm) and ribbon fiber

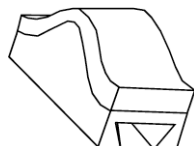

SPECIFICATIONS

LFD-201, LFD-202 and LFD-202E

Optical Characteristics, Typical

Optical tone receiver	270 Hz, 1 kHz, 2 kHz
Detection technique	Non-destructive macrobending
Loss	< 0.6 dB at 1310 nm
Spectral response	800 nm to 1650 nm
Minimum fiber slack	1.2 cm (1/2 in) required for detection

Core Power Detection, Typical ^a

LFD-201	0 dBm to -40 dBm
LFD-202	0 dBm to -40 dBm
LFD-202E	23 dBm to -50 dBm

Fiber Compatibility

Dual window, singlemode	8 µm to 10 µm core diameter
Coating diameter	250 µm diameter
Coating	High refractive index, acrylate

GENERAL SPECIFICATIONS

Size (H x W x D)	236 mm x 30 mm x 32 mm	(9 5/16 in x 1 3/16 in x 1 1/4 in)
Weight	0.3 kg	(0.6 lb)
Battery	Standard 9 V alkaline battery	
Battery life	Approx. 5000 readings	
Temperature		
Operating	-20 °C to 50 °C	(-4 °F to 122 °F)
Storage	-40 °C to 60 °C	(-40 °F to 140 °F)
Humidity	0 % to 90 % non-condensing at 35 °C	

OPTIONAL ACCESSORIES

- Optional interchangeable 2 mm head
- Optional interchangeable 1.6 mm head

Includes: LFD-200 carrying case, three interchangeable adapter heads, user guide, 9 V alkaline battery and Certificate of Compliance.

NOTE

a. At 1550 nm.

ORDERING INFORMATION

LFD-20X-X

■ Live fiber detector

- LFD-201 = Standard live fiber detector without core power reading display
- LFD-202 = Live fiber detector with core power reading display
- LFD-202E = Core power reading display (23 dBm to -50 dBm)

■ Additional heads

- 00 = No additional heads
- 01 = With 2 mm interchangeable head
- 02 = With 1.6 mm interchangeable head
- 03 = With 2 mm and 1.6 mm interchangeable heads

Example: LFD-201-01

Rugged Handheld Solutions

OPTICAL <ul style="list-style-type: none"> OTDRs OLTSs Power meters Light sources Talk sets 	COPPER ACCESS <ul style="list-style-type: none"> ADSL/ADSL2+, SHDSL, VDSL test sets VoIP and IPTV test sets Ethernet test sets POTS test sets
---	--

Platform-Based Solutions

OPTICAL FIBER <ul style="list-style-type: none"> OTDRs OLTSs ORL meters Variable attenuators 	DWDM TEST SYSTEMS <ul style="list-style-type: none"> OSAs PMD analyzers Chromatic dispersion analyzer 	TRANSPORT AND DATACOM <ul style="list-style-type: none"> Next-generation SONET/SDH and OTN testers SONET/DSn (DS0 to OC-192) testers SDH/PDH (64 kbit/s to STM-64) testers T1/T3, E1 testers 10/100 Mbit/s and Gigabit Ethernet testers Fibre Channel testers 10 Gigabit Ethernet testers
---	---	---

EXFO Corporate Headquarters > 400 Godin Avenue, Quebec City (Quebec) G1M 2K2 CANADA | Tel.: 1 418 683-0211 | Fax: 1 418 683-2170 | info@EXFO.com

Toll-free: 1 800 663-3936 (USA and Canada) | www.EXFO.com

EXFO America	3701 Plano Parkway, Suite 160 Plano, TX 75075 USA	Tel.: 1 800 663-3936	Fax: 1 972 836-0164
EXFO Europe	Omega Enterprise Park, Electron Way Chandlers Ford, Hampshire S053 4SE ENGLAND	Tel.: +44 2380 246810	Fax: +44 2380 246801
EXFO Asia	151 Chin Swee Road, #03-29 Manhattan House SINGAPORE 169876	Tel.: +65 6333 8241	Fax: +65 6333 8242
EXFO China	No. 88 Fuhua, First Road, Central Tower, Room 801 Futian District Beijing New Century Hotel Office Tower, Room 1754-1755 No. 6 Southern Capital Gym Road Beijing 100044 P. R. CHINA	Tel.: +86 (755) 8203 2300 Tel.: +86 (10) 6849 2738	Fax: +86 (755) 8203 2306 Fax: +86 (10) 6849 2662

EXFO is certified ISO 9001 and attests to the quality of these products. This device complies with Part 15 of the FCC Rules. Operation is subject to the following two conditions: (1) this device may not cause harmful interference, and (2) this device must accept any interference received, including interference that may cause undesired operation. EXFO has made every effort to ensure that the information contained in this specification sheet is accurate. However, we accept no responsibility for any errors or omissions, and we reserve the right to modify design, characteristics and products at any time without obligation. Units of measurement in this document conform to SI standards and practices. In addition, all of EXFO's manufactured products are compliant with the European Union's WEEE directive. For more information, please visit www.EXFO.com/recycle. Contact EXFO for prices and availability or to obtain the phone number of your local EXFO distributor.

For the most recent version of this spec sheet, please go to the EXFO website at <http://www.EXFO.com/specs>
In case of discrepancy, the Web version takes precedence over any printed literature.